

Common Mode Choke Coils

Type: **3S**

Japan



Common mode choke coil for use as an EMI noise suppression filter for high frequency signal lines and cables. Low price, small size and SMD made using automatic winding and composite ferrite material.

■ Features

- Small size (3.4×2.5×2.8 mm)
- Magnetic shield type

■ Recommended Applications

- Communication equipment
- Office Automation equipment
- Audio Visual equipment
- Electronic musical instruments and game machines

■ Explanation of Part Numbers

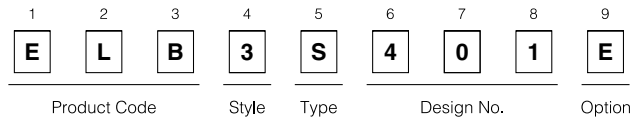

■ Examples

Part No.	Impedance	Voltage	Current	DC Resistance
ELB3S401E	1000 Ω min. (100 MHz)	50 V DC max.	0.2 A max.	0.8 Ω max. (typ. 0.5 Ω)
ELB3S402E	300 Ω min. (100MHz)	50 V DC max.	0.2 A max.	0.5 Ω max. (typ. 0.3 Ω)

■ Example of Impedance vs. Frequency Characteristics

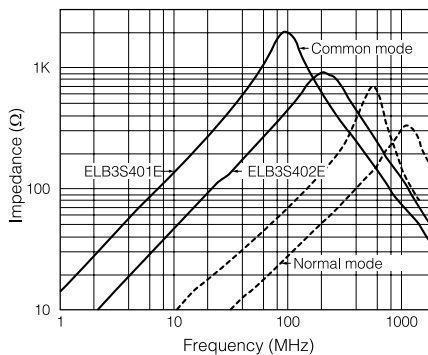

Test Circuit Diagram

- Common mode impedance

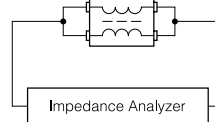

- Normal mode impedance

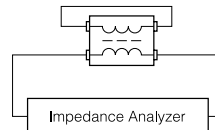

■ Dimensions in mm (not to scale)

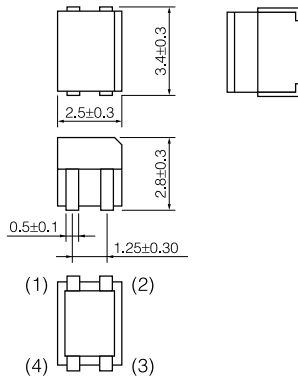

● Recommended Land Pattern in mm (not to scale)

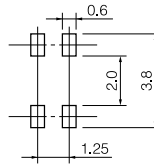

● Connection (up view)

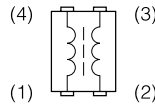

■ Packaging Methods

● Standard Packing Quantity

Packaging	Embossed Carrier Taping
Quantity	1000 pcs./reel

● Embossed Carrier Tape Dimensions in mm (not to scale)

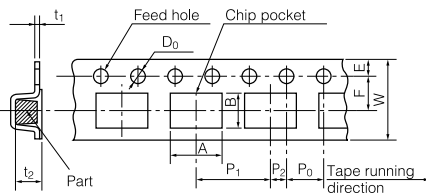

A	B	W	E	F	P ₁	P ₂	P ₀	D ₀	t ₁	t ₂
3.1	3.8	12.0	1.75	5.5	4.0	2.0	4.0	φ1.5	0.3	3.0

● Reel Dimensions in mm (not to scale)

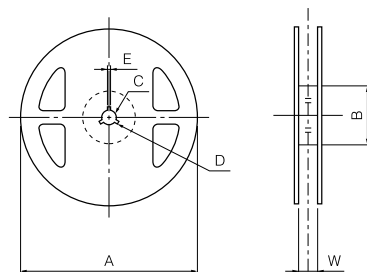

A	B	C	D	E	W
φ180	φ60 min.	φ13	φ21	2	13