

Power Inductors for Surface Mounting

TYPE : 7004D-1S/1L

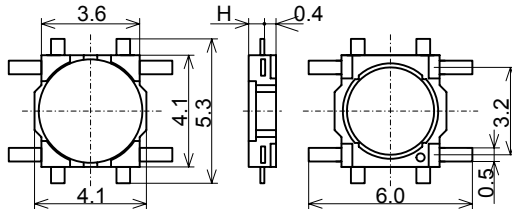

Frequency Range:~1MHz
Inductance Range:1~270 μ H
Temperature Coefficient: \pm 10%max.



H=0.8max : 7004D-1S
H=1.0max : 7004D-1L

TYPE : 7004D-1M/1N/1H



Frequency Range:~1MHz
Inductance Range:1~470 μ H
Temperature Coefficient: \pm 10%max.

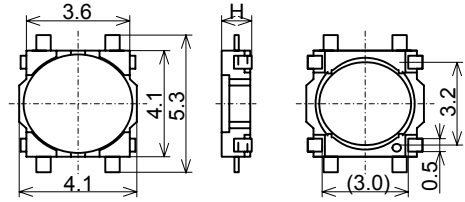

H=1.2max : 7004D-1M
H=1.4max : 7004D-1N
H=1.8max : 7004D-1H

■ Features

SMD magnetic shielded type of power inductor
Suitable as power supply choke coil

■ Specifications

Inductance Code	Inductance (μ H)	DC Resistance (Ω) \pm 30%			Rated DC Current (A)		
		7004D-1S/1M	7004D-1L/1N	7004D-1H	7004D-1S/1M	7004D-1L/1N	7004D-1H
2R2	2.2	0.087	0.077	0.058	1.000	1.400	1.700
2R7	2.7	0.097	0.092	0.063	0.900	1.200	1.500
3R3	3.3	0.120	0.100	0.071	0.800	1.100	1.400
3R9	3.9	0.130	0.110	0.085	0.770	1.050	1.300
4R7	4.7	0.150	0.140	0.100	0.750	1.000	1.200
5R6	5.6	0.170	0.160	0.120	0.650	0.950	1.050
6R8	6.8	0.200	0.200	0.150	0.620	0.860	0.980
8R2	8.2	0.240	0.220	0.170	0.540	0.820	0.900
100	10	0.320	0.270	0.210	0.500	0.740	0.830
120	12	0.380	0.310	0.250	0.450	0.690	0.770
150	15	0.470	0.360	0.300	0.400	0.620	0.650
180	18	0.560	0.490	0.360	0.350	0.530	0.620
220	22	0.690	0.580	0.430	0.300	0.460	0.570
270	27	0.810	0.750	0.500	0.270	0.430	0.520
330	33	1.050	0.850	0.570	0.250	0.390	0.470
390	39	1.200	1.050	0.770	0.220	0.370	0.450
470	47	1.350	1.150	0.840	0.200	0.330	0.420
560	56	1.500	1.600	1.100	0.190	0.300	0.370
680	68	2.000	1.800	1.300	0.180	0.260	0.350
820	82	2.300	2.000	1.600	0.170	0.240	0.300
101	100	3.300	2.300	1.900	0.160	0.220	0.280
121	120	3.700	3.100	2.400	0.150	0.200	0.240
151	150	4.600	3.600	2.800	0.130	0.180	0.220
181	180		4.200	3.900		0.160	0.200
221	220		6.000	5.700		0.140	0.180
271	270		7.000	6.400		0.130	0.160
331	330			7.300			0.140
391	390			8.300			0.130
471	470			9.500			0.120

Notes: 1. Measurement Frequency for Inductance: 100kHz($< 10 \mu$ H) 1kHz($\geq 10 \mu$ H)
2. Rated DC Current: Value of inductance decrease within 10%.

Inductance range

Tolerance	7004D-1S/1M	7004D-1L/1N	7004D-1H
\pm 20%(M)	2.2~150 μ H	2.2~270 μ H	2.2~470 μ H

Recommended Land Pattern

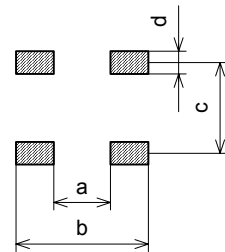

Type	a	b	c	d
7004D-1S/1L	4.1	7.0	3.2	0.9
7004D-1M/1N/1H	2.4	4.6	3.2	0.9

Parts code

7004D-1S	—	101	M
Type		Inductance code	Tolerance

Chip Inductors for Surface Mounting

Type 7004D-1S/1L, 7004D-1N/1N1H Series Electric Characteristics

Characteristics of DC Resistance

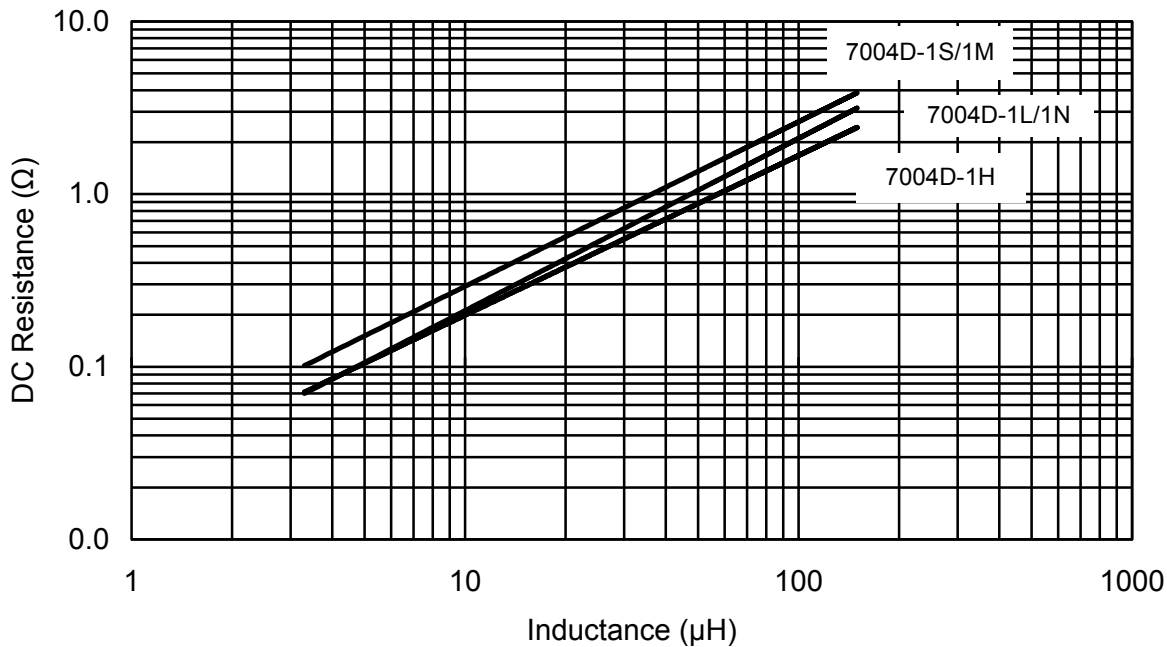

Characteristics of DC Superposition

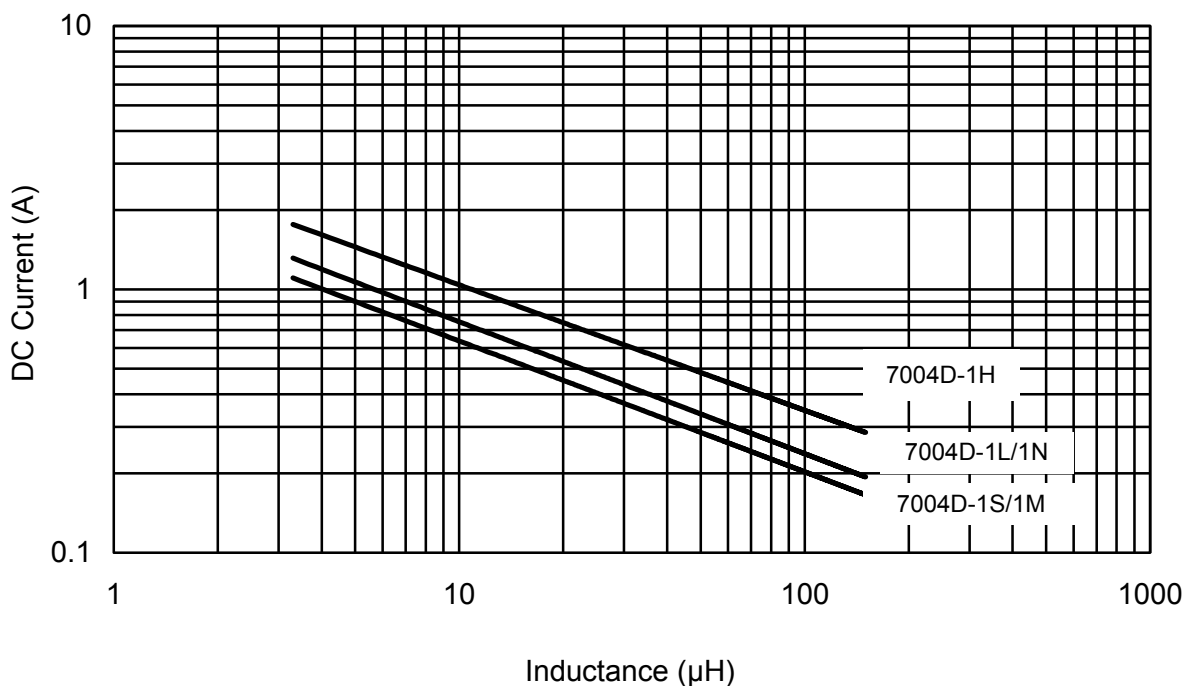

Notes: 1. Graphs are based on typical values of each type, not spec. values.
2. DC current value is being measured at 10% decrease of inductance.

