

RF Components

Band Pass Filters Shielded

DEA-B Series

FEATURES

- Compact, low profile, and light weight.
- Low insertion loss, high attenuation.
- Shielded type.

TEMPERATURE RANGES

Operating	−40 to +85°C
Storage	−40 to +85°C

SHAPES AND DIMENSIONS

DEA321897BT-2001/DEA322448BT-2005/DEA322448BT-2009

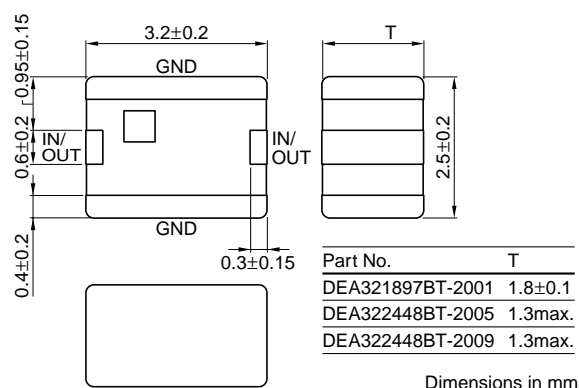

RECOMMENDED PC BOARD PATTERN

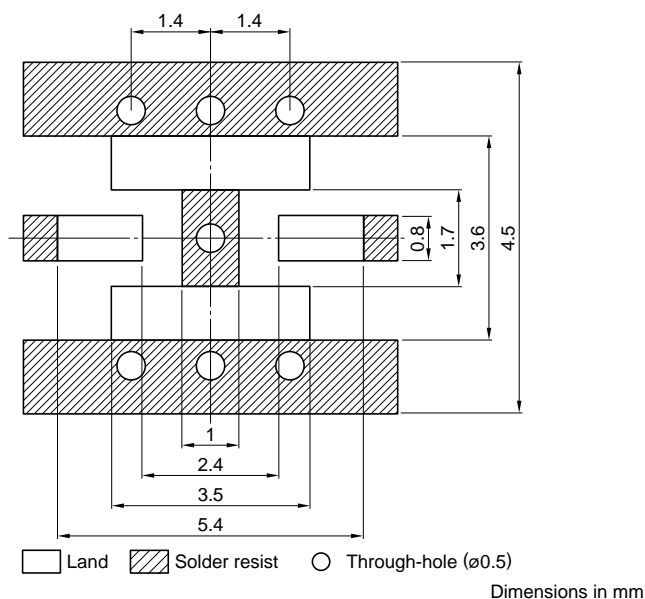

APPLICATIONS/TYPICAL ELECTRICAL CHARACTERISTICS

Part No.	Applications	Center frequency fo(MHz)	Bandpass width (MHz)	Insertion loss (dB)max.	Attenuation (dB)min.
DEA321897BT-2001	DCS/PCS	1897	185	2.5	30[at 2fo]
DEA322448BT-2005	Bluetooth	2448	97	2.8	30[at 2fo]
DEA322448BT-2009	Bluetooth	2448	97	2.2	30[at 2fo]

• Company and product names mentioned are registered trademarks.

TYPICAL ELECTRICAL CHARACTERISTICS

DCS/PCS

DEA321897BT-2001

- 1: 1190.0MHz, −35.260dB 4: 1990.0MHz, −2.0348dB
 2: 1590.0MHz, −19.240dB 5: 2410.0MHz, −38.205dB
 3: 1805.0MHz, −1.9384dB

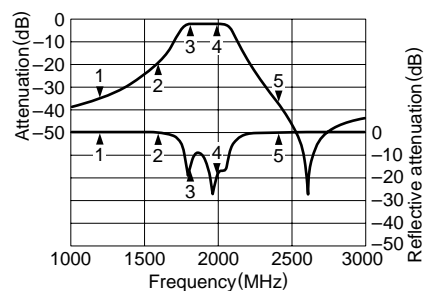

Bluetooth

DEA322448BT-2005

- 1: 2400.0MHz, −2.2746dB 4: 4800.0MHz, −39.798dB
 2: 2497.0MHz, −2.1410dB 5: 7200.0MHz, −36.603dB
 3: 1990.0MHz, −43.860dB

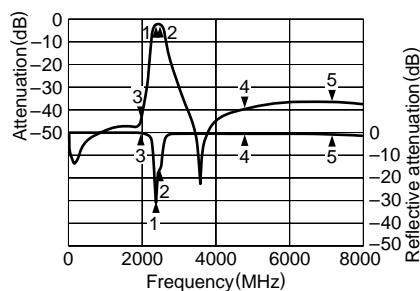

Bluetooth

DEA322448BT-2009

- 1: 2400.0MHz, −1.5937dB 4: 2170.0MHz, −23.052dB
 2: 2497.0MHz, −1.3768dB 5: 4800.0MHz, −36.765dB
 3: 1990.0MHz, −42.383dB

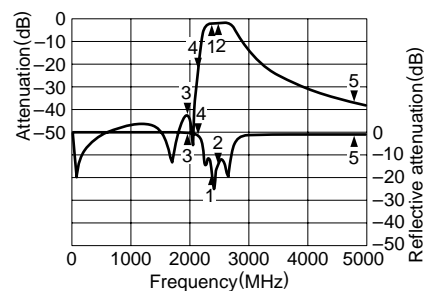

RF Components

DEA-B Series

Band Pass Filters

Shielded

RECOMMENDED REFLOW SOLDERING CONDITIONS

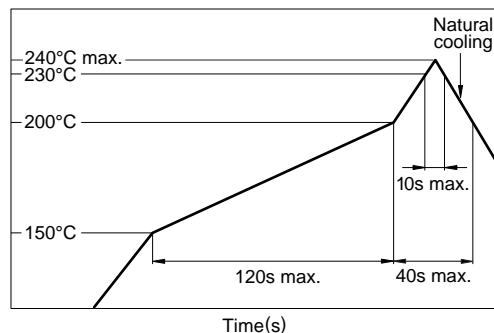

APPLICATION EXAMPLE

CONSTRUCTION OF BLUETOOTH

DEA322448BT-2005(3.2×2.5×1.3mm)
DEA322448BT-2009(3.2×2.5×1.3mm)

